

宁波九隆五金有限公司  
NINGBO JIULONG HARDWARE CO.,LTD.

LIFTING SOLUTION PRODUCTS

2023  
EDITION

BE WITH US,  
BE WITH SAFETY!

宁波九隆五金有限公司

NINGBO JIULONG HARDWARE CO.LTD

NINGBO JIULONG INTERNATIONAL CO.LTD

公司地址：浙江·宁波·宁海科技工业园区B区8号

Add: NO.B-8Technology Industrial Park Ninghai  
Ningbo,China

Office Add: Room 508,Guangbo International Centre,  
No.1357 Yinxian Road,Ningbo,China

电话 ( Tel ) : 86-574-82815295/82815299

传真 ( Fax ) : 86-574-82815296

邮编 ( P.C ) : 315100

网址 ( Http ) : www.jlhardware.com

邮箱 ( Email ) : sales@jlhardware.com







## VC-D TYPE MANUAL CHAIN BLOCK

Model	Capacity (T)	Standard lift(M)	Running test load(T)	No. of falls of load chain	Load chain diameter(MM)	Dimensions (MM)					Net weight (KG)
						A	B	C	D	Hmin	
VC-D 0.5T	0.5	2.5	0.75	1	5	132	148	23	35	345	11
VC-D 1T	1	2.5	1.5	1	6	151	172	27	40	376	12.5
VC-D 1.5T	1.5	2.5	2.25	1	7.1	173	196	33	45	442	17.8
VC-D 2T	2	2.5	3	1	8	175	210	35	50	470	19.5
VC-D 3T	3	3	4.5	2	7.1	176	230	39	55	565	29
VC-D 5T	5	3	7.5	2	9	189	280	45	65	688	41.3
VC-D 10T	10	3	1.5	4	9	189	463	54	75	765	78.5

## VK TYPE MANUAL LEVER BLOCK

Model	Capacity (T)	Standard lift(M)	Running test load(T)	No. of falls of load chain	Load chain diameter(MM)	Dimensions (MM)					Net weight (KG)
						A	B	C	D	K	
VK 0.75T	0.75	1.5	1.125	1	6	158	92	160	37	29	7.4
VK 1.5T	1.5	1.5	2.25	1	7.1	173	99	145	42.5	33.5	11.4
VK 3T	3	1.5	4.5	1	10	200	112	199	50	40	20.8
VK 6.0T	6	1.5	9	2	10	200	112	230	53	42.5	28.1
VK 9.0T	9	1.5	13.5	3	10	200	112	338	67	53	48.9

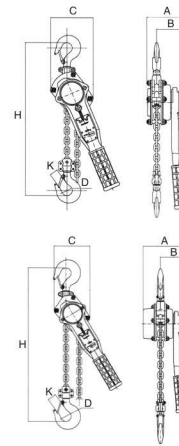
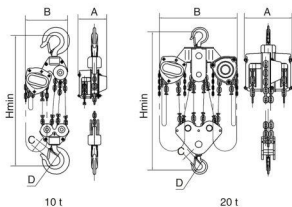
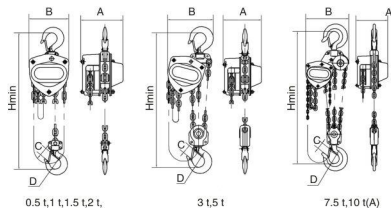



**VC-B TYPE MANUAL CHAIN BLOCK**

Model	Capacity (T)	Standard lift(M)	Running test load(T)	No. of falls of load chain	Load chain diameter(MM)	Dimensions (MM)			Net weight(KG)
						A	B	C	
VC-B 0.5T	0.5	2.5	0.75	1	5	129	136	270	8.4
VC-B 1T	1	2.5	1.5	1	6.3	149.5	145	317	12
VC-B 1.5T	1.5	2.5	2.25	1	7.1	157.5	164.5	399	16.2
VC-B 2T	2	3	3	1	8	161.5	187	414	20
VC-B 3T	3	3	4.5	2	7.1	151.5	164.5	465	24
VC-B 5T	5	3	7.5	2	9	163	211	636	41
VC-B 10T	10	3	15	4	9	207	398	798	79
VC-B 20T	20	3	30	8	9	215	650	890	193
VC-B 30T	30	3	45	12	9	350	680	1380	220
VC-B 50T	50	3	75	24	9	406	962	2578	1092

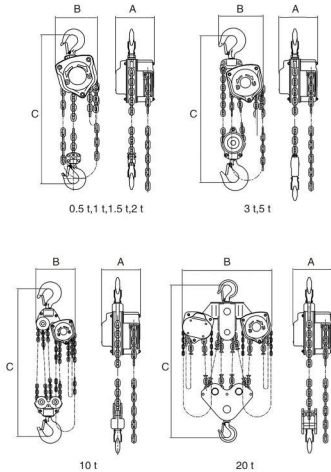

**VL-TYPE MANUAL LEVER BLOCK**

Model	Capacity (T)	Standard lift(M)	Running test load(T)	No. of falls of load chain	Load chain diameter (MM)	Dimensions (MM)			Net weight (KG)
						A	B	C	
V 0.5T	0.5	1.5	0.75	1	5	102	80	95	3.5
VL 0.75T	0.75	1.5	1.125	1	6.3	155	88	135	6.6
VL 1.5T	1.5	1.5	2.25	1	7.1	170	110	162	11
VL 3.0T	3	1.5	4.5	1	9	198	120	211	17
VL 6.0T	6	1.5	9	2	9	198	120	254	27.5
VL 9.0T	9	1.5	13.5	3	9	198	120	319	47

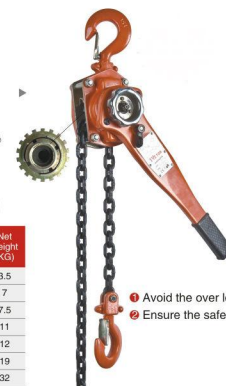
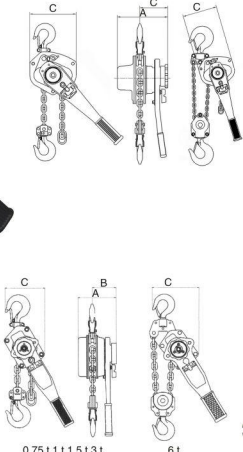

**VA-TYPE MANUAL LEVER BLOCK**

Model	Capacity (T)	Standard lift(M)	Running test load (T)	No. of falls of load chain	Load chain diameter (MM)	Dimensions (MM)			Net weight (KG)
						A	B	C	
V 0.5T	0.5	1.5	0.75	1	5	102	80	95	3.5
VA 0.75T	0.75	1.5	1.125	1	6	148	87.5	135	7
VA 1T	1	1.5	1.5	1	6	4148	87.5	135	7.5
VA 1.5T	1.5	1.5	2.25	1	8	176	102	157	11
VA 2T	2	1.5	3	1	8	176	102	57	12
VA 3.0T	3	1.5	4.5	1	10	195	109	210	19
VA 6.0T	6	1.5	9	2	10	195	109	253	32

- ⚠ Avoid the over loading
- ⚠ Ensure the safe working



## VIT WIRE ROPE WINCH

Model Item	VIT-600	VIT-1600	VIT-3200	VIT5400
Rated forward hand power (N)	941	438	438	745
Rated capacity (T)	900	1600	3200	5400
Rated forward travel (MM)	≥52	≥55	≥28	≥30
Rope diameter (MM)	8.3	11	16	20
Wire rope safety factor load capacity (TIMES)	5	5	5	5
Max traveling load (KG)	1200	2400	4000	8000
Net weight (KG)	6.4	12	28	56
Max outer size (MM)	A	B	C	D
	426	545	660	930
	B	238	284	325
	C	64	97	116
	L1 (CM)	80	80	80
	L2 (CM)	80	120	120
Packing (L*W*H) (CM)	43*6.4*24	54.5*9.7*29	66*12*35	110*110*73

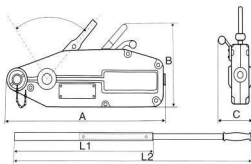

## V1 TYPE MANUAL CHAIN BLOCK

Capacity (T)	0.25
Standard Lift (M)	2
Running testload (KG)	3.75
Loadchaindiameter (MM)	4
Headroom (MM)	230
No. of load chain fall	1
loadchaindiameter (MM)	4*12
Dimensions (MM)	A
	B
	C
	D
	E
	E1
	Φ
Net weight (KG)	3.5

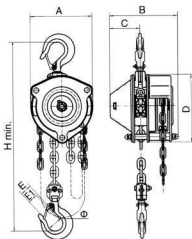

## V2 TYPE LEVER BLOCK

Capacity (T)		0.25
Standard Lift (M)		1
Running testload (KG)		3.75
No. of falls of load chain		1
Loadchaindiameter (MM)		4
Net weight (KG)		1.8
Dimensions (MM)	A	92
	B	72
	C	85
	D	30
	H	230
	L	160
	K	25

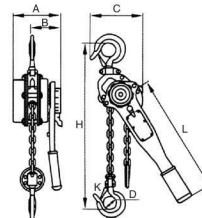

## V3 TYPE LEVER BLOCK

Capacity (KG)	250	500
Lift Height (M)	1	1.5
Test Load (KG)	3.75	7.5
Headroom (MM)	215	255
No. of load chain fall	1	1
Hand-pull L/R Force (N)	125	180
Chain Dia. (MM)	4*12	5*15
Net weight (KG)	0.35	0.55





## GCT-A PLAIN TROLLEY

Capacity (T)	I-Beam width(MM)	Net weight (KG)	Rated Load(KN)	Dimensions (MM)			
				A	B	C	H
0.5T	68-126	5	6.25	208	216	200	150
1T	80-146	8.7	12.5	242	260	253	170
2T	80-168	10.4	25	280	300	310	180
3T	88-168	24	37.5	300	345	357	190
5T	100-180	36	62.5	316	395	400	210

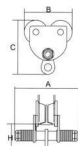

## CST-E2 TYPE PLAIN TROLLEY

Capacity (T)	I-Beam width (MM)	Net weight (KG)	Rated Load (KN)	Min Radius of curve (M)	Dimensions (MM)					
					A	B	C	E	K	
0.5T	64-152	8.6	6.25	0.9	264	216	195	31	110	
1T	64-203	15.4	12.5	1	335	260	239	32.5	136	
2T	88-203	23	25	1.1	353	300	286	31	161	
3T	102-203	40	37.5	1.3	371	345	336	35	185	
5T	114-203	50	62.5	1.4	393	390	393	37	220	
10T	125-203	97	125	1.7	436	470	500	45	280	

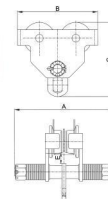

## GCL-A GEARED TROLLEY

Capacity (T)	I-Beam width(MM)	Net weight (KG)	Rated Load(KN)	Dimensions (MM)			
				A	B	C	H
0.5T	68-126	7.8	6.25	283	213	200	150
1T	80-146	11.2	12.5	317	260	253	170
2T	80-168	13	25	360	300	310	180
3T	88-168	27	37.5	380	345	357	190
5T	100-180	39	62.5	400	395	400	210

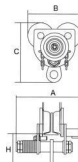

## CSL-E2 TYPE GEARED TROLLEY

Capacity (T)	I-Beam width (MM)	Net weight (KG)	Rated Load (KN)	Min Radius of curve (M)	Running Height (M)	Chain Pull To lift Full Load(N)	Dimensions (MM)			
							A	B	C	E
1T	64-203	19.9	12.5	1	3	44	390	260	239	32.5
2T	88-203	28.5	25	1.1	3	80	400	300	286	31
3T	102-203	46	37.5	1.3	3	65	430	345	336	35
5T	114-203	57	62.5	1.4	3	90	444	390	393	37
10T	125-203	103	125	1.7	3	195	489	470	500	45

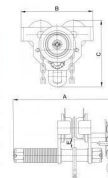

## GCT-B PLAIN TROLLEY

Capacity (T)	I-Beam width(MM)	Net weight (KG)	Rated Load(KN)	Dimensions (MM)			
				A	B	C	H
0.5T	68-128	5.3	6.25	208	200	200	150
1T	80-146	8.7	12.5	242	216	253	170
2T	80-168	10.4	25	280	260	310	180
3T	88-168	24	37.5	300	300	357	190
5T	100-180	36	62.5	316	345	400	210
10T	122-203	83	125	343	395	520	220

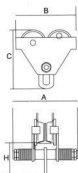

## CST-Y4 TYPE PLAIN TROLLEY

Capacity (T)	I-Beam width (MM)	Net weight (KG)	Rated Load (KN)	Min Radius of curve (M)	Dimensions (MM)					
					A	B	C	E	K	L
0.5T	50-220	8.2	6.25	0.9	292	225	173	33	25	30
1T	58-220	10.3	12.5	1	300	252	188	31	30	35
2T	66-220	17.5	25	1.1	310	300	226	32	40	47
3T	74-220	30.7	37.5	1.3	324	360	289	46	48	58
5T	90-220	42.4	62.5	1.4	329	392	313	47	60	70

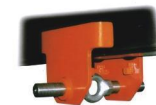
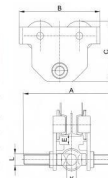

## GCL-B GEARED TROLLEY

Capacity (T)	I-Beam width(MM)	Net weight (KG)	Rated Load(KN)	Dimensions (MM)			
				A	B	C	H
0.5T	68-126	8	6.25	283	200	200	150
1T	80-146	11.8	12.5	317	216	253	170
2T	80-168	14.5	25	360	260	310	180
3T	88-168	27.6	37.5	380	300	357	180
5T	100-180	40.2	62.5	400	345	400	210
10T	122-203	86	125	443	395	520	220
20T	122-203	220	250	465	630	568	290

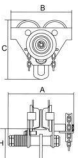

## CSL-Y4 TYPE GEARED TROLLEY

Capacity (T)	I-Beam width (MM)	Net weight (KG)	Rated Load (KN)	Min Radius of curve (M)	Running Height (M)	Dimensions (MM)					
						A	B	C	E	K	L
0.5T	50-220	11.4	6.25	0.9	3	292	225	173	33	25	30
1T	58-220	14.7	12.5	1	3	300	252	188	31	30	35
2T	66-220	21.8	25	1.1	3	314	300	226	32	40	47
3T	74-220	36.7	37.5	1.3	3	350	360	289	46	48	58
5T	90-220	48.5	62.5	1.4	3	359	392	313	47	60	70

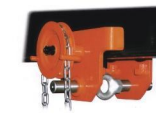
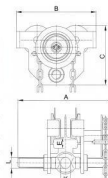



## LC-H1 TYPE LIFTING CLAMP

Model	Rated Capacity (T)	Test Load (T)	Jaw opening (MM)	Net weight (KG)
0.75T	0.75	1.5	0-25	2.4
1T	1	2	0-30	3.4
2T	2	4	0-35	5.4
3T	3	6	0-40	6
4T	4	8	0-45	6.3
5T	5	10	0-55	7.5

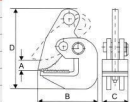

## LC-H2 TYPE LIFTING CLAMP

Model	Rated Capacity (T)	Test Load (T)	Jaw opening (MM)	Net weight (KG)
1T	1	2	1-13	2.1
2T	2	4	3-22	4.7
3T	3	6	12-35	8.4

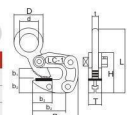

## LC-V1 TYPE LIFTING CLAMP

Model	Rated Capacity (T)	Test Load (T)	Jaw opening (MM)	Net weight (KG)
1T	1	2	0-22	4.5
2T	2	4	0-32	6.8
3T	3	6	0-36	11
5T	5	10	0-50	17.2

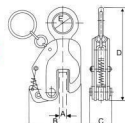

## LC-V2 TYPE LIFTING CLAMP

Model	Rated Capacity (T)	Test Load (T)	Jaw opening (MM)	Net weight (KG)
0.75T	0.75	1.5	0-15	2
1T	1	2	0-20	4.6
2T	2	4	0-30	8
3T	3T	6	0-25	15
5T	4T	8	0-30	20.4
8T	8T	16	0-45	34

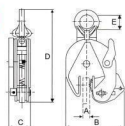

## LJ-Q TYPE GIRDER CLAMP

Model	Rated Capacity (T)	Test Load (kN)	Adjustable Beam Width (MM)	Dimensions (MM)								Net Weight (KG)			
				A		B		C	D	E	F		G	H	
				max	min	max	min				max				
1t	1	12.5	75-230	240	192	367	94	4	194	102	154	22	20	4	
2t	2	25	75-230	240	192	367	102	6	194	102	154	22	20	4.8	
3t	3	37.5	80-345	355	243	520	132	8	241	133	223	38	22	9.8	
5t	5	62.5	80-345	355	243	520	142	10	241	133	223	35	28	11.6	
10t	10	125	90-350	360	272	532	180	12	284	155	234	47	38	17	

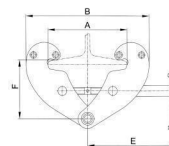

## LJ-Q1 TYPE GIRDER CLAMP

Model	Rated Capacity (T)	Test Load (kN)	Adjustable Beam Width (MM)	Dimensions (MM)								Net Weight (KG)			
				A		B		C	D	E	F		G	H	
				max	min	max	min				max				
1t	1	12.5	75-230	240	192	367	94	4	218	103	155	20	30	4.2	
2t	2	25	75-230	240	192	367	102	6	218	103	155	20	30	5.1	
3t	3	37.5	80-320	330	243	491	132	8	258	157	223	47	45	10.4	
5t	5	62.5	80-320	330	243	491	142	10	258	157	223	47	45	12.2	
10t	10	125	90-320	330	259	501	180	12	293	175	235	56	64	18.8	

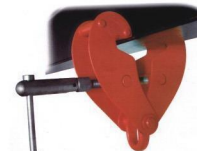
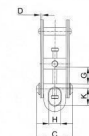
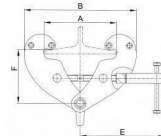

## DRUM LIFTER

Capacity	Opening Size (MM)	Net weight (KG)	Packing (CM)
1T*0.6M	0-25	3.4	17*13.5*8.5







## JQ Mechanical Jack

Model	Rated Capacity (T)	Test Load (KN)	Chain shake to lift full load (N)	Stroke (MM)	Dimensions (MM)											Net weight (KG)
					A	B	C	D	E	F	H	K	R			
1.5T	1.5	18.5	150	300	163	2.6	289	160	55	25	600	113	225	14.8		
3T	3	36.8	280	350	197	2.19	316	170	60	40	735	127	250	23.3		
5T	5	61.3	280	350	189	258	355	200	70	40	735	127	275	31.3		
10T	10	122.5	560	410	250	318	523	220	86	40	805	248	300	49		

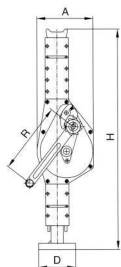

1.5t-3t

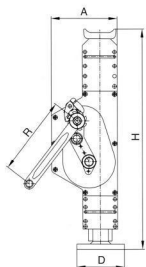

5t-10t

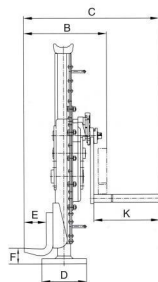

## RSC TYPE JACK

Model	Outside diameter (MM)	Inferior diameter (MM)	Collapsed (MM)	Net weight (KG)	Travel (MM)
10T	64	45	157	3.4	100
20T	89	65	160	6.2	100
30T	109	80	164	9.6	100
50T	129	100	166	12.6	100
100T	179	135	176	26.5	100
150T	209	170	176	40	100
200T	248	196	181	65	100



## DY SINGLE SNATCH BLOCK

Type		S.W.L. (T)	Sheave dia D (MM)	For wire dia (MM)	Net weight (KG)
Hook	Eye				
75DY*1S	75YD*1SO	0.5	75	8	1.5
100DY*1S	100YD*1SO	1	100	10	2.6
125DY*1S	125YD*1SO	1.5	125	13	4.8
150DY*1S	150YD*1SO	2	150	16	7.4
180DY*1S	180YD*1SO	3	180	19	11.9
200DY*1S	200YD*1SO	4	200	22	20.4
2500DY*1S	250YD*1SO	5	250	25	33
300DY*1S	300YD*1SO	6	300	26	48



## DY DOUBLE SNATCH BLOCK

Type		S.W.L. (T)	Sheave dia D (MM)	For wire dia (MM)	Net weight (KG)
Hook	Eye				
75DY*2S	75YD*2SO	0.5	75	8	2.8
100DY*2S	100YD*2SO	1	100	10	4.3
125DY*2S	125YD*2SO	1.5	125	13	7.8
150DY*2S	150YD*2SO	2	150	16	12.2
180DY*2S	180YD*2SO	3	180	19	18.5
200DY*2S	200YD*2SO	4	200	22	31
2500DY*2S	250YD*2SO	5	250	25	49.5
300DY*2S	300YD*2SO	6	300	26	72
350DY*2S	350YD*2SO	10	350	28	102



## H418 SNATCH BLOCK

Model	Size (IN)	W.L.L. (T)	For wire dia (IN)	Net weight (KG)
WDL5703	3	2	3/8	2.25
WDL5705	4 1/2	4	1/2	5.6
WDL5706	6	8	3/4	12.1
WDL5708	8	8	3/4	15
WDL5710	10	8	3/4	21.5
WDL5712	12	8	3/4	26
WDL5714	14	8	3/4	36
WDL5716	16	15	7/8	54



## H419 SNATCH BLOCK

Model	Size (IN)	W.L.L. (T)	For wire dia (IN)	Net weight (KG)
WDL5803	3	2	3/8	2.25
WDL5805	4 1/2	4	1/2	5.85
WDL5806	6	8	3/4	12.5
WDL5808	8	8	3/4	16.5
WDL5810	10	8	3/4	21.5
WDL5812	12	8	3/4	29.5
WDL5814	14	8	3/4	39.5
WDL5816	16	15	7/8	62





## CARGO LASHING BELT

The cargo lashing belt is applicable to the binding, fastening of goods and Tow truck self rescue during the transportation. Prepare assemblies(doubleline hook, triangle ring, etc.)according to actual needs.  
Note:it can not be used to lift goods.

1. Raw material of strap:100%high strength polyester yarn
2. Width of strap:20mm~100mm
3. Color of strap: orange, blue,yellow,red and black
4. Length of product:1m~50m
5. Choice range of product' s breaking force:0.5t~10t



## WEBBING SLING

1. Raw material of strap:100%high strength polyester yarn
2. Single-layer strap and double-layer strap
3. Strengthened hoisting hole
4. Low ductility
5. Production length:1m~20m



## SAFETY DEVICES

### 1.The Electromagnetic Brake

Electromagnetic brake is featured by its unique brake design— It immediately operates when power cuts off(when it is fully-loaded).

### 2.The Mechanical Load Brake

The mechanical Load brake effectively prevents the hoist descending too fast even if fully loaded.The Mechanical Load Brake operates independently so if the Electromagnetic Brake fails the Mechanical Load Brake will still function.

### 3. Hook and Safety Tongue

The hook is constructed of anti-pull and heat-treated steel and meets required standards.The lower-hook can turn 360 degree, it's tongue provides a guarantee for safety

### 4. The Back-Phase Protector

The back-phase protects the motor from overheating in the case of wrong phase position.

### 5. Limit Switch

The power will cut off automatically when the hoist ascends or descends to its limit.

### 6.The Emergency-Stop Switch(if selected)

This switch is used to stop the hoist in an emergency.The red and mushroom-shaped switch is located on the top of the switch controller.When pressed and held down,the power will be cut off and the switch be locked.A clockwise-turn can unlock it and restart the hoist.

## HBB ELECTRIC CHAIN HOIST

Model	Capacity (T)	Lifting Motor						Operating motor						L-Beam (CM)
		Lifting speed (M/min)	Power (KW)	Rotation speed (M/min)	Phases	Voltage (V)	Frequency (Hz)	Power (KW)	Rotation speed (M/min)	Operating speed (M/min)	Phases	Voltage (V)	Frequency (Hz)	
0.5T-01	0.5	7.8	1.1	1440	3	220-440	50	0.12	1440	24	3	220-440	50	58-127
1T-01	1	6.9	1.5	1440	3	220-440	50	0.4	1440	11/21	3	220-440	50	68-130
1T-02	1	3.9	1.1	1440	3	220-440	50	0.4	1440	11/21	3	220-440	50	68-130
2T-01	2	6.6	3.0	1440	3	220-440	50	0.4	1440	11/21	3	220-440	50	82-153
2T-02	2	3.4	1.5	1440	3	220-440	50	0.4	1440	11/21	3	220-440	50	82-153
3T-01	3	5.6	3.0	1440	3	220-440	50	0.75	1440	11/21	3	220-440	50	100-178
3T-02	3	4.4	3.0	1440	3	220-440	50	0.75	1440	11/21	3	220-440	50	100-178
5T-02	5	2.8	3.0	1440	3	220-440	50	0.75	1440	11/21	3	220-440	50	100-178